

Product Reference Guide

neoheel™ Safety Lancet

Quick Reference Guide

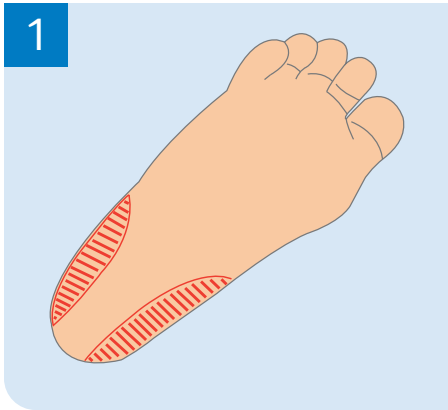

1 Select a site identified in the shaded areas above. Clean the incision site of the heel with an antiseptic swab and allow skin to air dry.

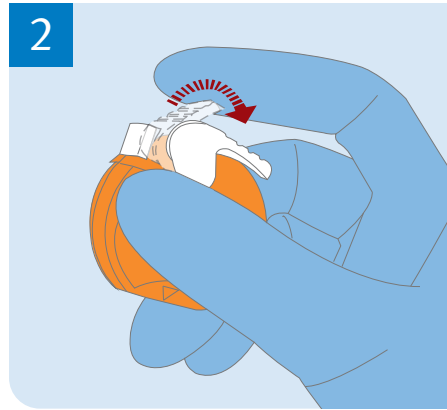

2 Release trigger lock mechanism by pushing down the screw button.

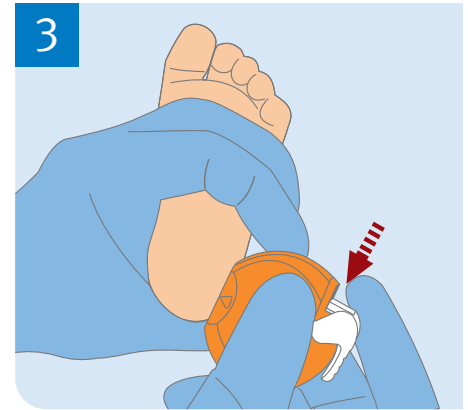

3 Place the blade slot surface of the device flush against heel site. Ensure that both ends of the device are in contact with the skin, and depress the trigger.

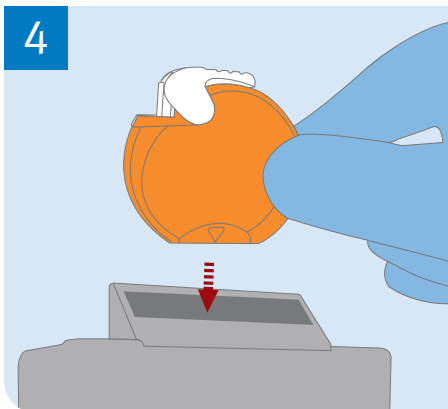

4 After triggering, immediately remove the device from infant's heel and discard it into a suitable sharps container.

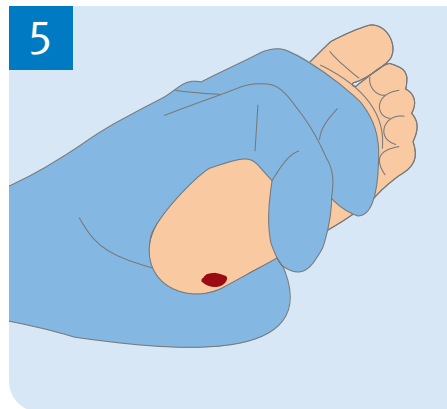

5 First drop of blood should be wiped away gently with a dry sterile swab. Apply gentle pressure with the thumb and ease intermittently as drops of blood form.

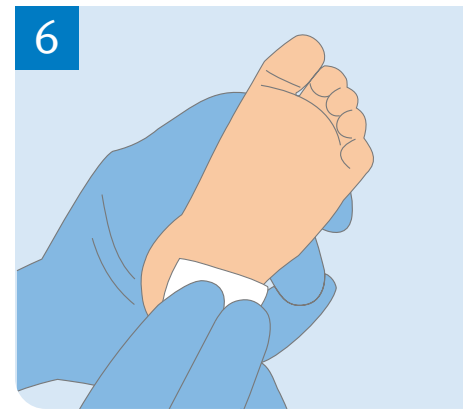

6 Following blood collection, gently press a dry sterile swab to the incision site until bleeding has ceased.

Rx Only For safe and proper use, refer to the Instructions for Use.
Figures are rendered as graphic representations to approximate actual product.